



Shelter & home-based enterprises

Victoria Maynard, Elizabeth Wagemann, Beth Simons, Fiona Kelling

Shelter and home-based work

Victoria Maynard, Elizabeth Wagemann,
Beth Simons, Fiona Kelling

UK Shelter Forum

13:10-14:00 - 23 April 2021

Format of the session

13:10-13:25 Presentations

Introduction – Victoria Maynard

Global scoping study – Beth Simons

LAC – Elizabeth Wagemann

Humanitarian - Fiona Kelling

13:25-13:45 Focus groups

13:45-14:00 Reporting and next steps

Introduction

Victoria Maynard

What shelter provides

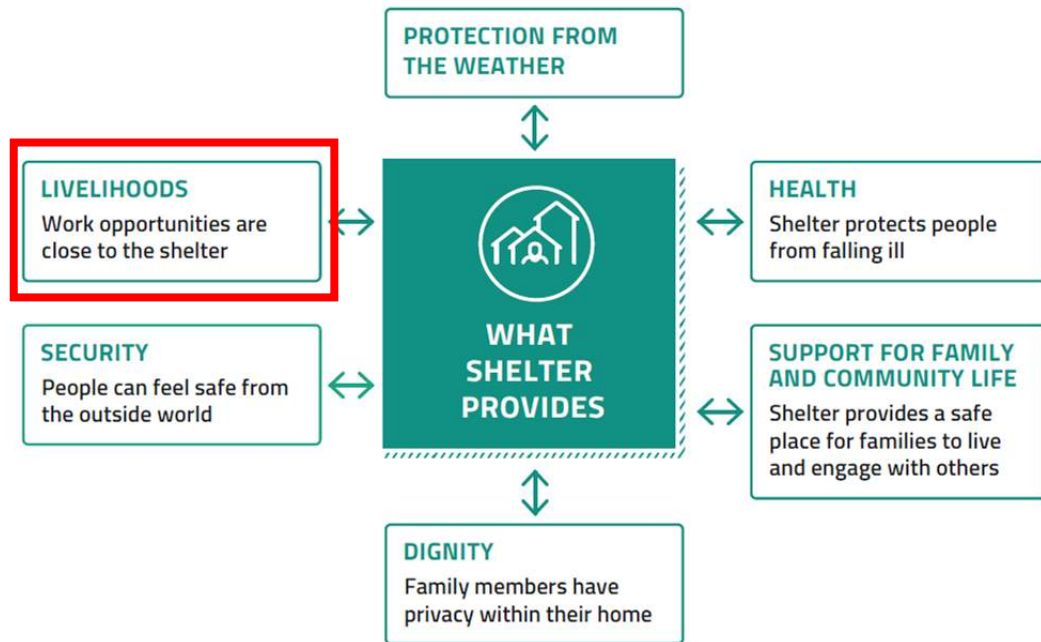

Sphere Handbook (2018) page 241



Shelter Projects Essentials (2021) page 3

My shelter is near my work

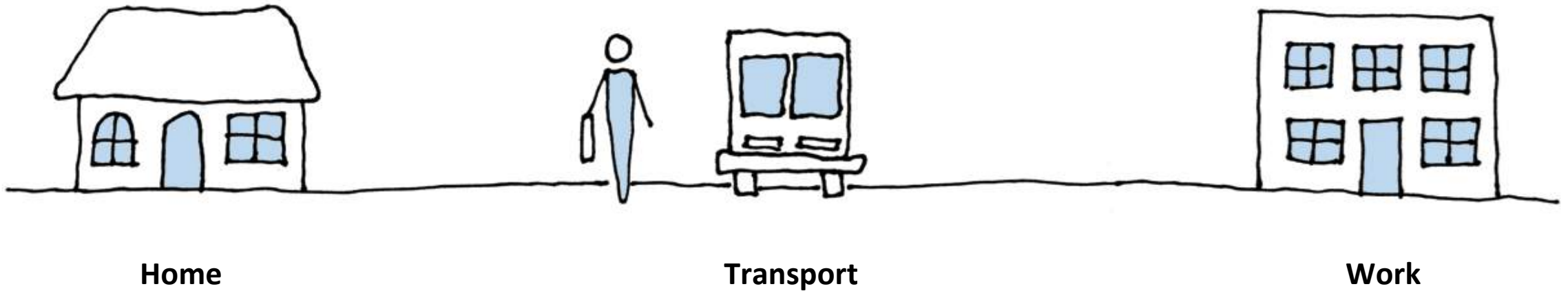

My shelter is where I work

20-50% of households run HBEs ([Gough, 2010](#))

HBEs provide 50-75% of household incomes
([Tipple et al., 2002](#))

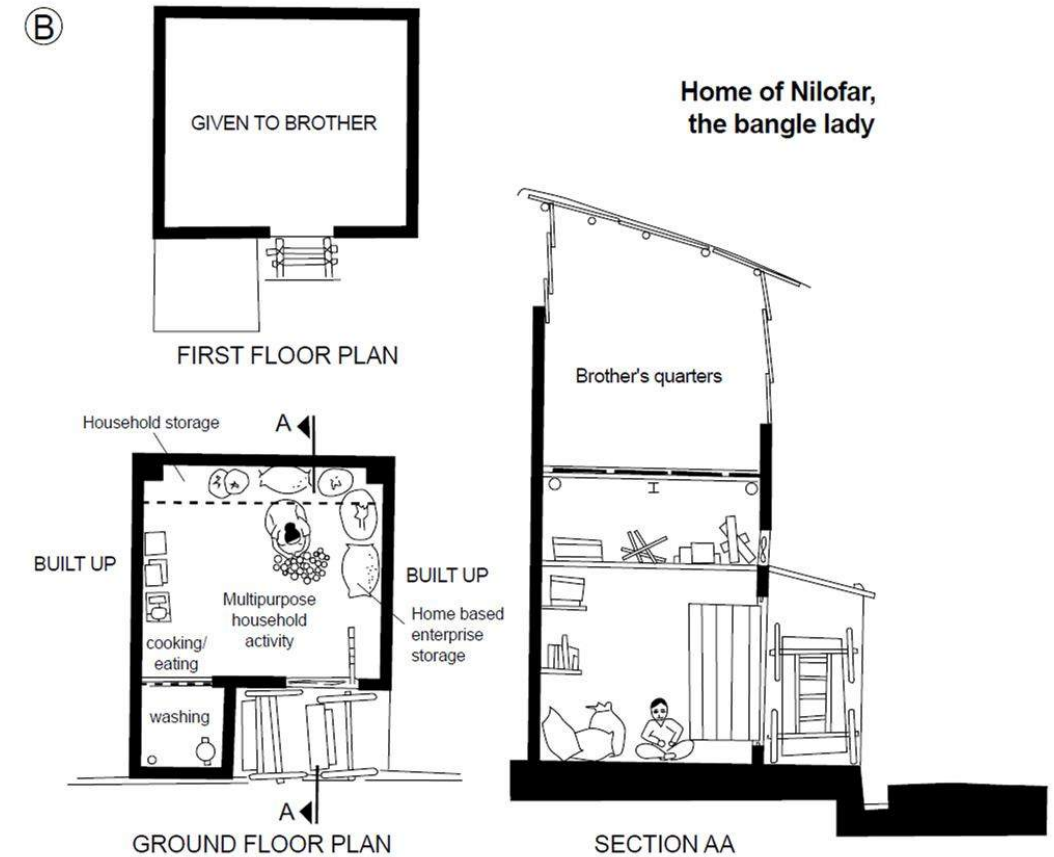
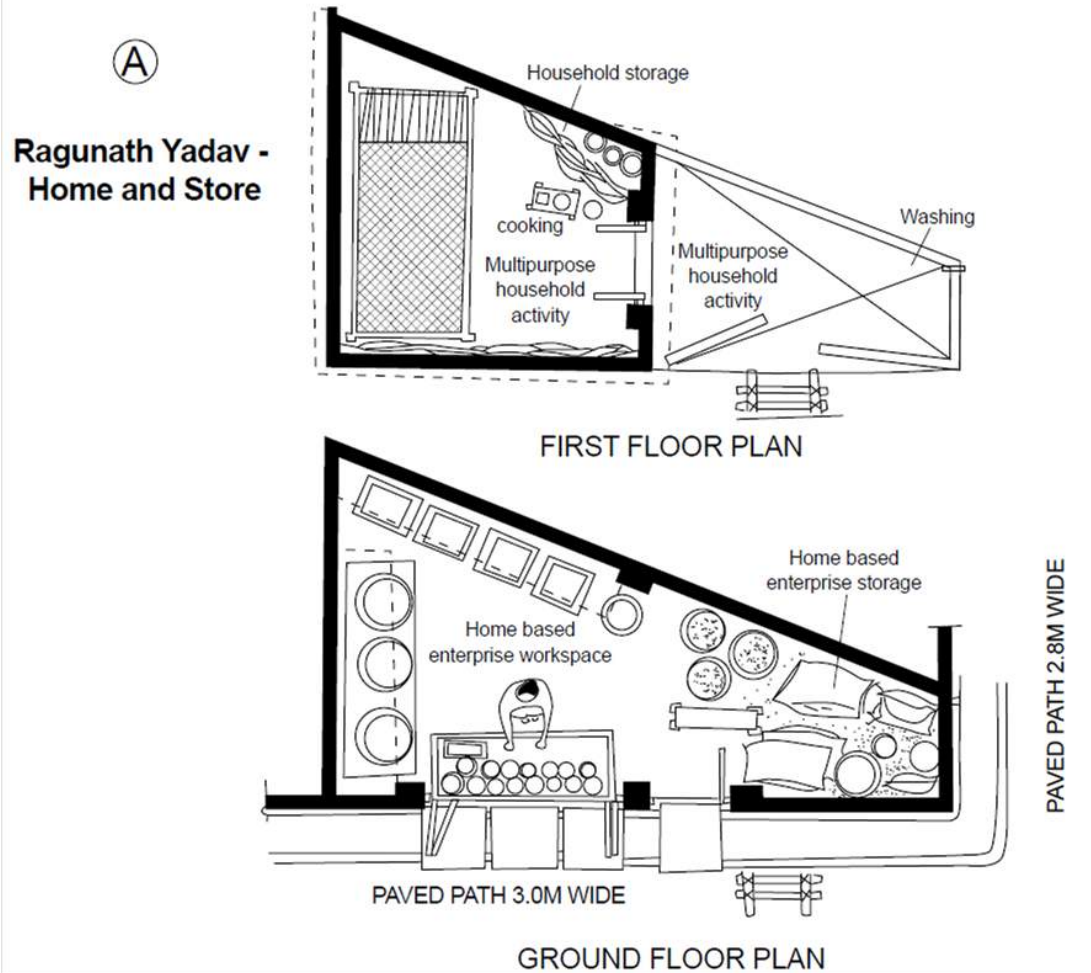

Drawings from [Tipple and Kellet \(2000\)](#)

My work affects my shelter



Table / Chair

Cooking
Tailoring
Hairdressing

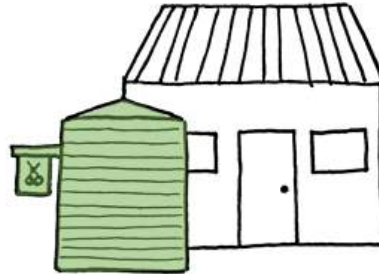

Shed

Hairdressing
Photocopying
Shop



Window

Shop
Takeaway

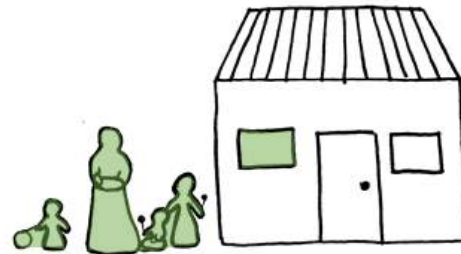

Room

Childcare
Dentistry
Sex work



Extension

Repairs
Shop
Café

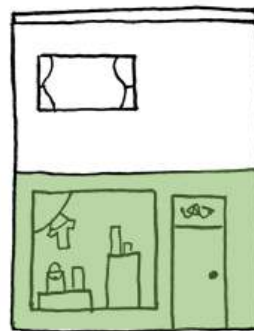

Floor

Shop
Restaurant
Manufacturing

Photo from: Wagemann (2017) PhD. Thesis



Women run 70-90% of HBEs ([Gough, 2012](#))

At least 50% more women work in households with HBEs than those without ([Tipple et al., 2002](#))

My shelter affects my work

HBEs are “the single most important income source for the populations most affected by disaster”
([Sheppard and Hill, 2005](#))



20 days after super typhoon Haiyan in the Philippines in 2013
“a man finds time to cut his neighbour's hair” ([Inquirer, 2013](#)).



Just over a month after the earthquake and tsunami on Sulawesi, Indonesia in 2018. Fatnizar, a seamstress, used the awning of the emergency tent to recommence work. ([ShelterBox, 2018](#)).

Global Scoping Study

Beth Simons



Research questions

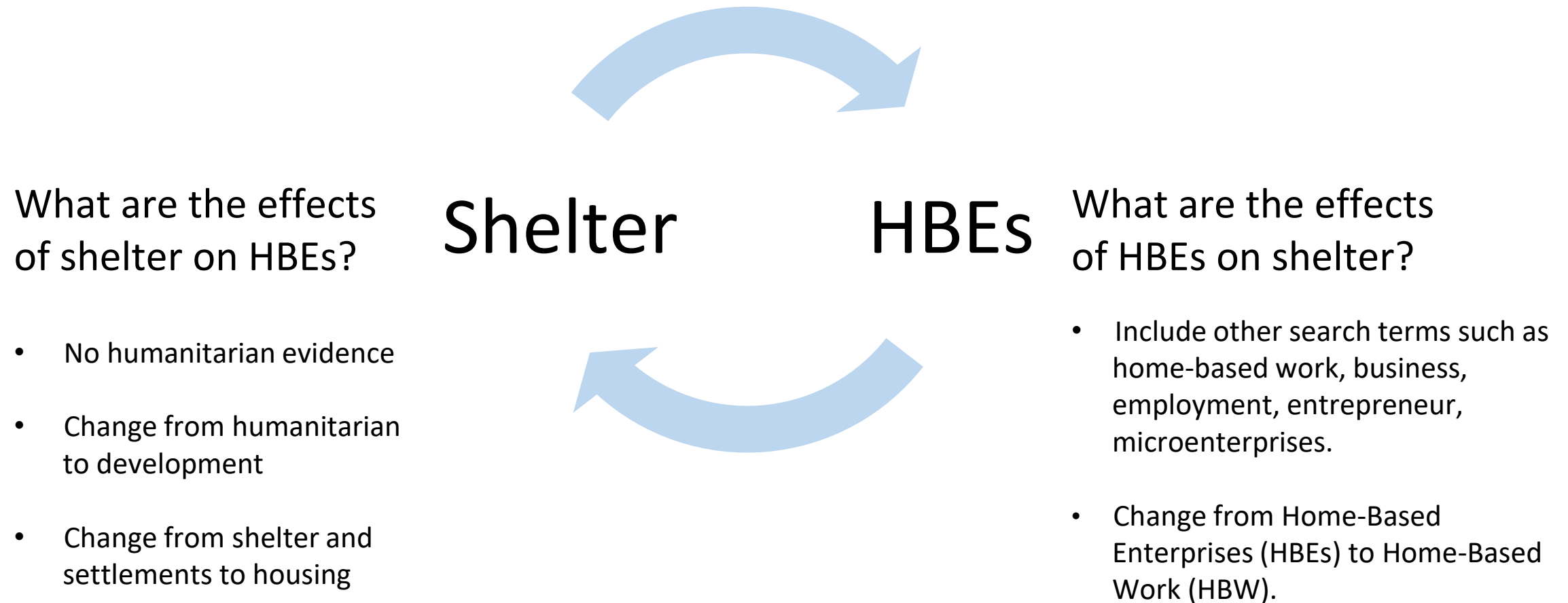

Research questions

What are the effects
of housing on HBW?

Housing

HBW

What are the effects
of HBW on housing?



Home-based work in poor lighting, India
([WIEGO, 2013](#))



No division between the home and workspace
([WIEGO, 2013](#))

Method

Final search: Google Scholar
search 2 April 2021

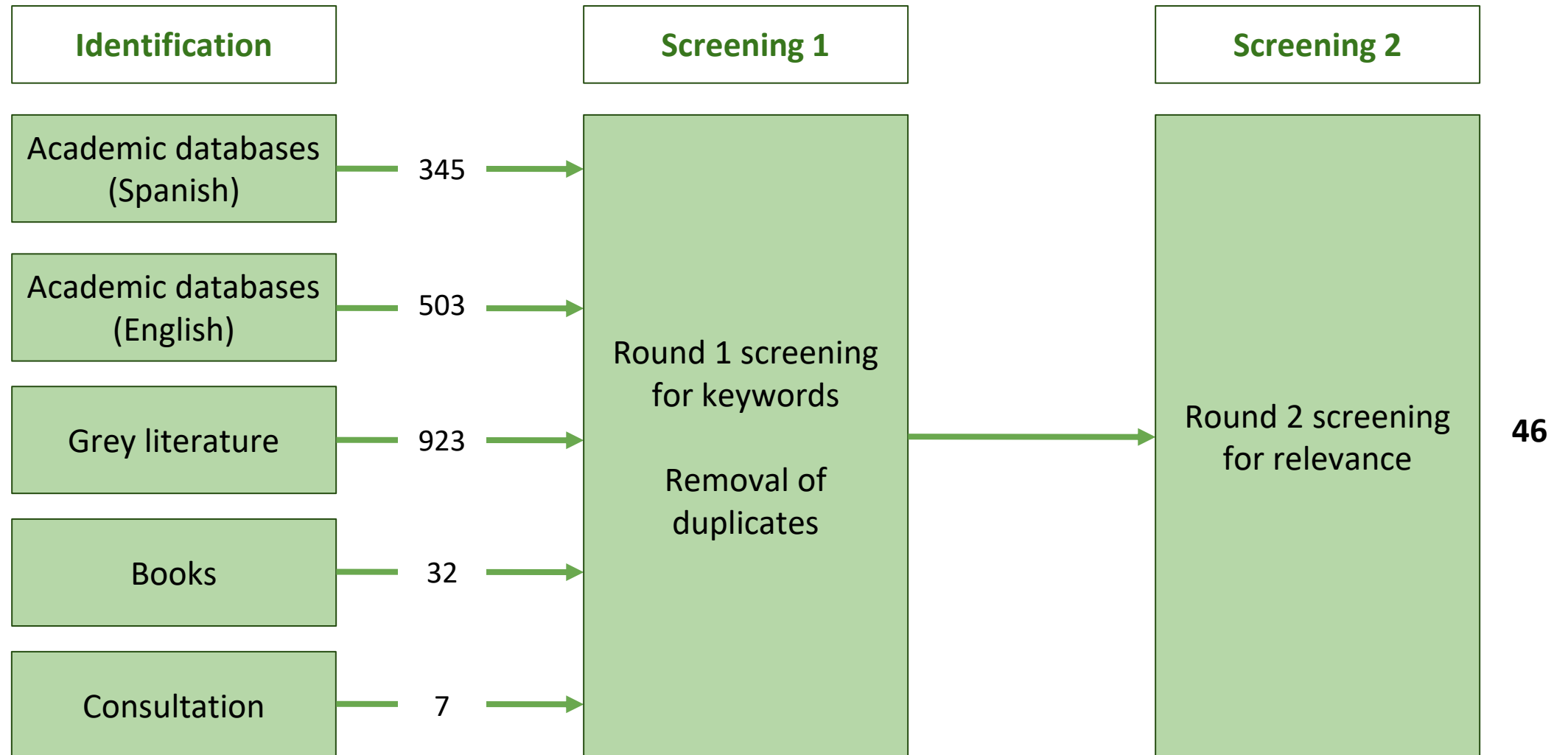

Findings

Locations

- Southeast Asia (21)
- Western Africa (11)
- Multi-country comparison studies (4)

Contexts

- Mostly development (all but 1)
- Humanitarian - rural, grey literature examples mostly about recovery after the Indian Ocean Tsunami and excluded due to lack of information.

Gaps in **Latin America and the Caribbean** and in the **Humanitarian** sector.



Home-based work in Lahore, Pakistan
([WIEGO, 2020](#))

Latin America and the Caribbean

Elizabeth Wagemann



Key findings from LAC

IN ENGLISH

Difficult to find the
right terms/keywords

Home-Based

- Enterprise (HBE)
- Business (HBB)
- Work (HBW)
- Economic Activities (HBEAs)
- Income Generation (HIG)

Key findings from LAC

IN ENGLISH

Difficult to find the right terms/keywords

Home-Based

- Enterprise (HBE)
- Business (HBB)
- Work (HBW)
- Economic Activities (HBEAs)
- Income Generation (HIG)

IN SPANISH

More difficult to find the right terms/keywords

Doméstico
Casa
Vivienda
Hogar

- Trabajo doméstico (NO)
- Trabajo en casa/ desde casa /en el hogar
- (Micro) empresas domésticas
- Vivienda-negocio
- Vivienda-taller
- Negocio familiar
- Casa/vivienda productiva

Key findings from LAC

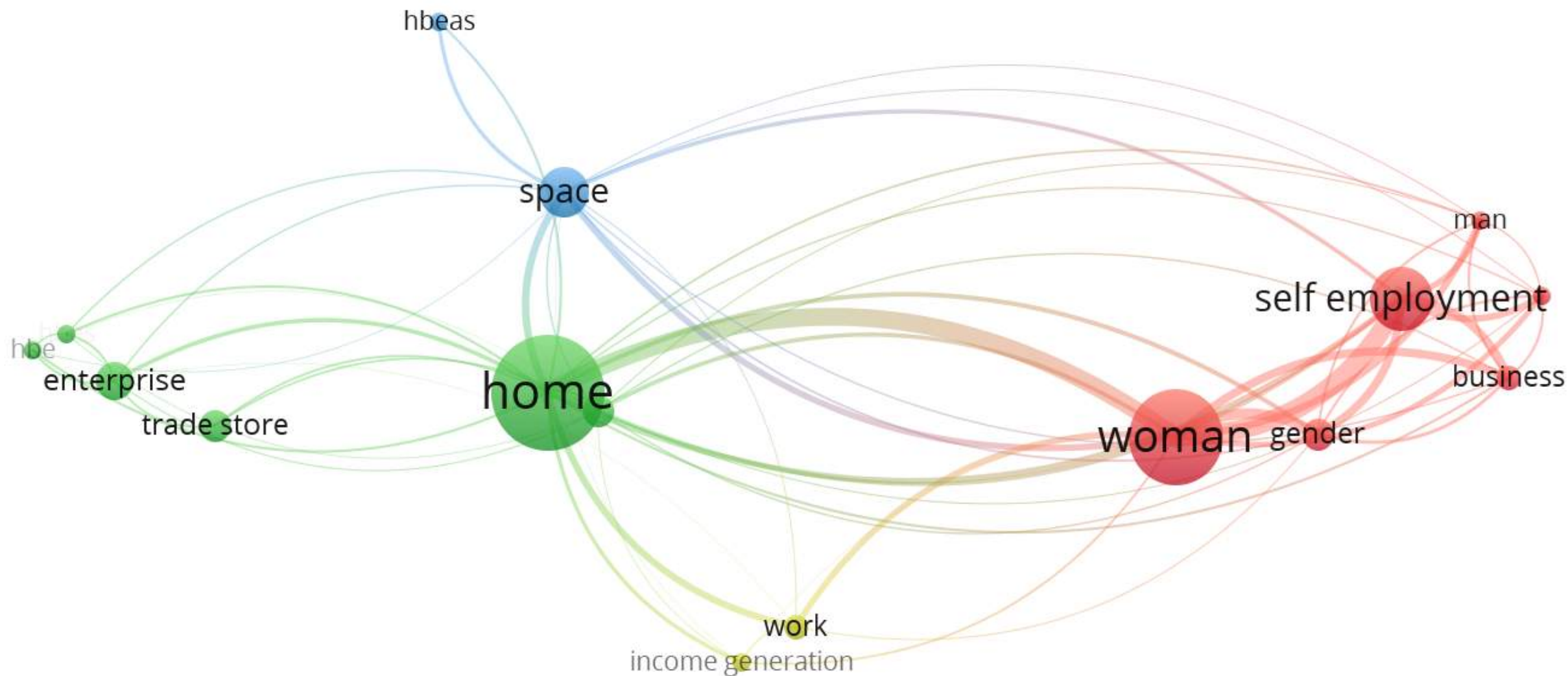

Proposal in Chile

Relations between domestic space and workspace.

Case: emergency housing after the 2015 hydro-meteorological event in Atacama.



Images: Adaptations of T-Shelters in Atacama, Chile.
Moris & Ketels (2016)

Proposal in Chile

Relations between domestic space and workspace.

Case: emergency housing after the 2015 hydro-meteorological event in Atacama.



Images: Adaptations of T-Shelters in Atacama, Chile.
Moris & Ketels (2016)

Proposal in Chile

Relations between domestic space and workspace.

Case: emergency housing after the 2015 hydro-meteorological event in Atacama.



Images: Adaptations of T-Shelters in Atacama, Chile.
Moris & Ketels (2016)

Previous work in Chile

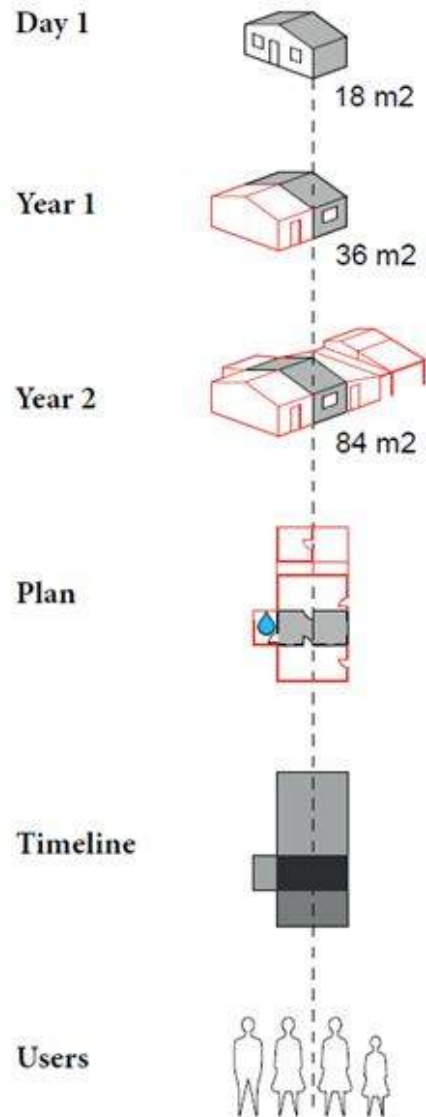

An example: Shelter as a process/ Housing trajectories

Use of T-Shelter as a fishing workshop (storage, gear and equipment) after 2010 Earthquake and tsunami. Curanipe, Chile. HBW was not the focus

More info: www.researchgate.net/profile/Elizabeth-Wagemann

- From Shelter to Home: Flexibility in Post-Disaster Accommodation (2017). PhD
- [Need for Adaptation. Transformation of Temporary Houses](#) (2017). Disasters Journal



Humanitarian

Fiona Kelling

Image: Modified temporary shelter in Dichato, Chile (2012). The government provided the shelter after the 2010 earthquake and tsunami. The extension accommodates a shop. Wagemann (2017) <https://doi.org/10.1111/disa.12228>

Initial evidence from The Wider Impacts of Shelter and Settlement Assistance Report:

“Provides more than shelter – it is a place in which employment and home-based enterprises occur, providing direct income as well as income for those it employs”

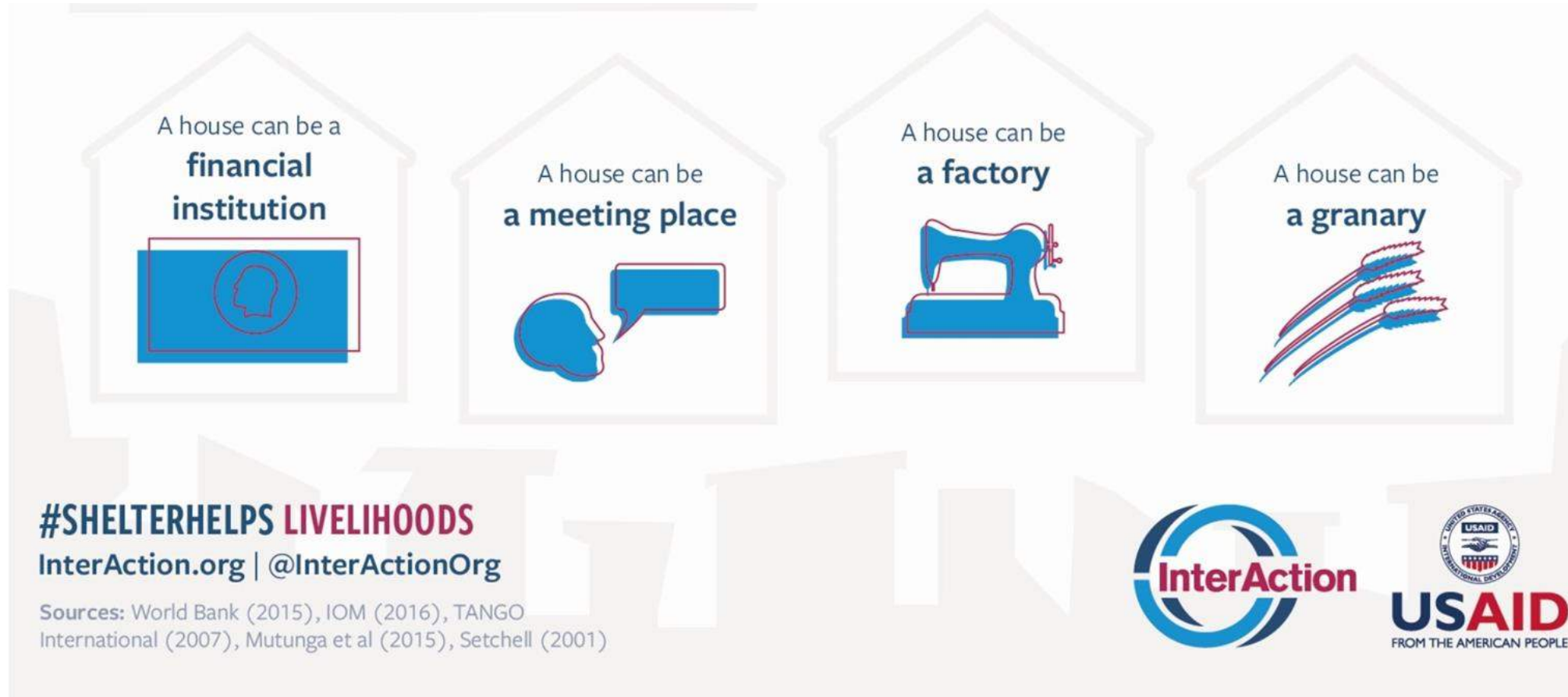

<https://www.interaction.org/blog/more-than-four-walls-and-a-roof/>

Assets received (tools or physical space) can be used to re-establish, maintain or generate livelihoods

- Continued to use t-shelters as additional living space or business premises (van Dijk and van Leersum 2009)
- 10% used shelters for business purposes – program extremely important in rebuilding livelihoods (TANGO International, 2007:21)
- Can be a platform for small business development (Sheppard and Hill, 2005:11)
- Shelter assistance allowed families to expand business (Shelter Project 2017/18: A8)
- Percentage destruction of dwellings is a proxy for percentage destruction of the means of livelihood (Martinez and Titiunik, n.d:17)



Many less detailed mentions in humanitarian literature

Suggestions on contributions?

Focus groups introduction

Victoria Maynard

1. How would you describe Home-Based Work? (Elizabeth) *Terminology*
1. What examples do you have of shelter and HBW from practice? (Beth) *Case studies*
1. When supporting shelter and HBW - what has worked well or not? (Fiona) *Lessons*
1. What is the most important issue in shelter and HBW? (Victoria) *Future research*

Focus groups feedback

Elizabeth Wagemann

How would you describe Home-Based Work?

Elizabeth Wagemann

What examples do you have of
shelter and HBW from practice?

Beth Simons

When supporting shelter and HBW - what has worked well or not?

Fiona Kelling

What is the most important issue in shelter and HBW?

Victoria Maynard

Conclusion

Beth Simons

Progress and next steps

- Roadmap 4 Research: Shelter and Home-based Enterprises
- Global scoping study: Housing and Home-Based Work
- LAC study: Housing and Home-Based Work in Latin America and the Caribbean
- Proposal in Chile
- Housing and home-based work: Implications for humanitarian shelter and settlements

Keep in touch

If you'd like to receive email updates about our research into housing and home-based work please sign up via:

- <https://rebrand.ly/housing-HBW>

If you'd like to get involved in the research in LAC please contact:

- elizabeth.wagemann@mail.udp.cl

Many thanks for your interest in our research!