

# A Platform approach to DfMA

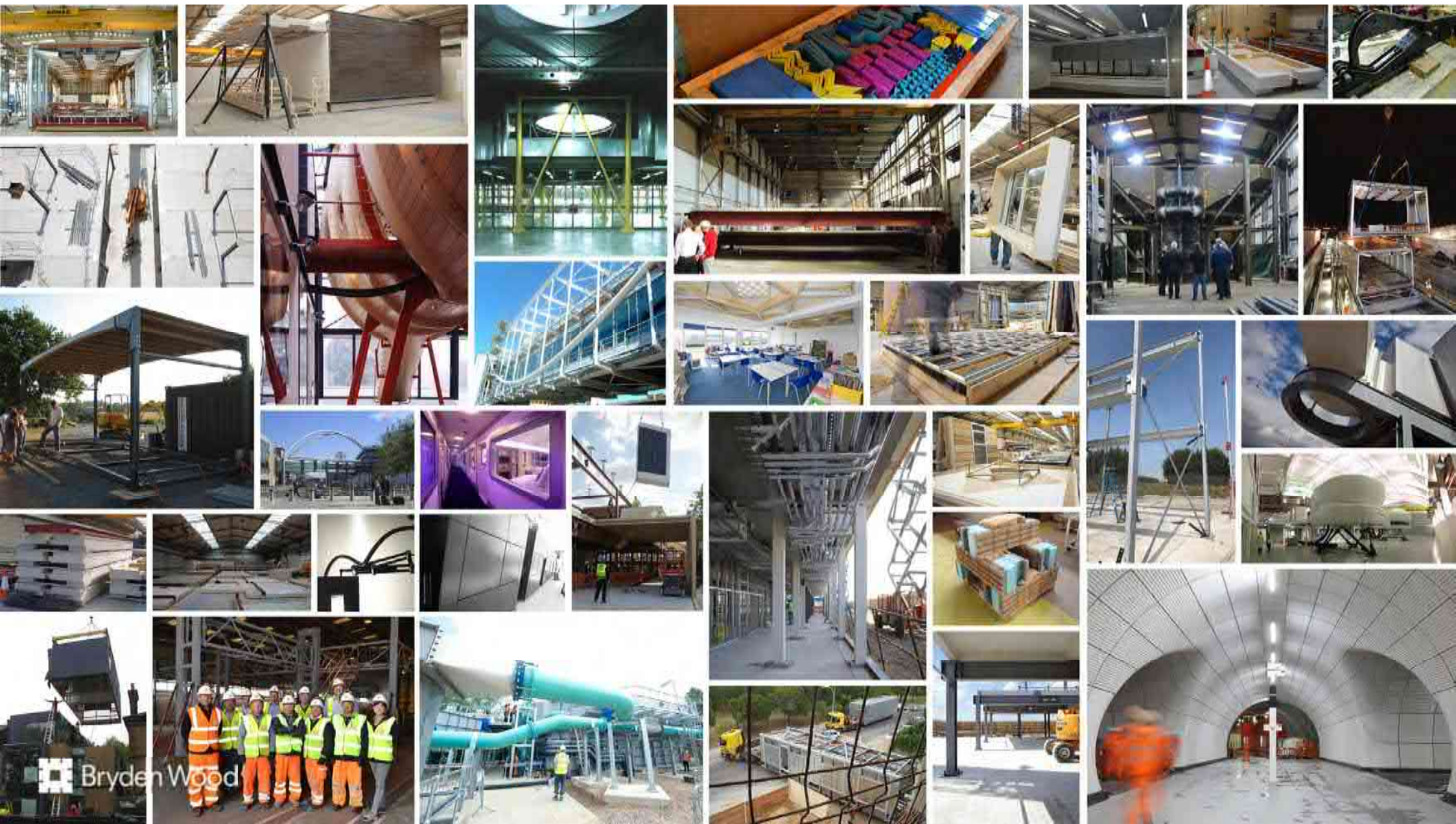

UK Shelter Forum 25  
25<sup>th</sup> October 2019



 Bryden Wood





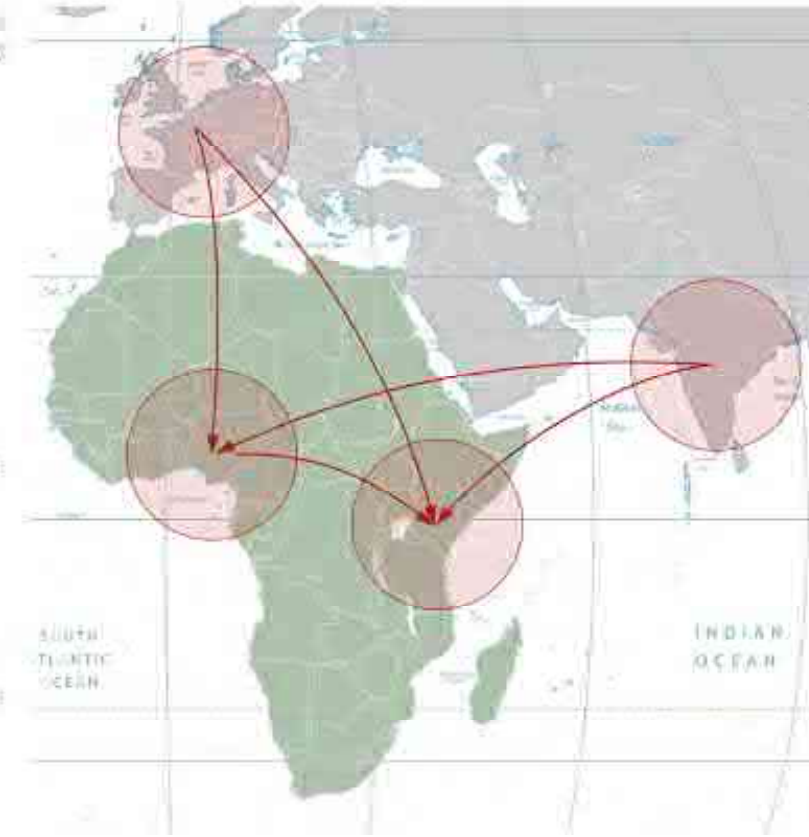
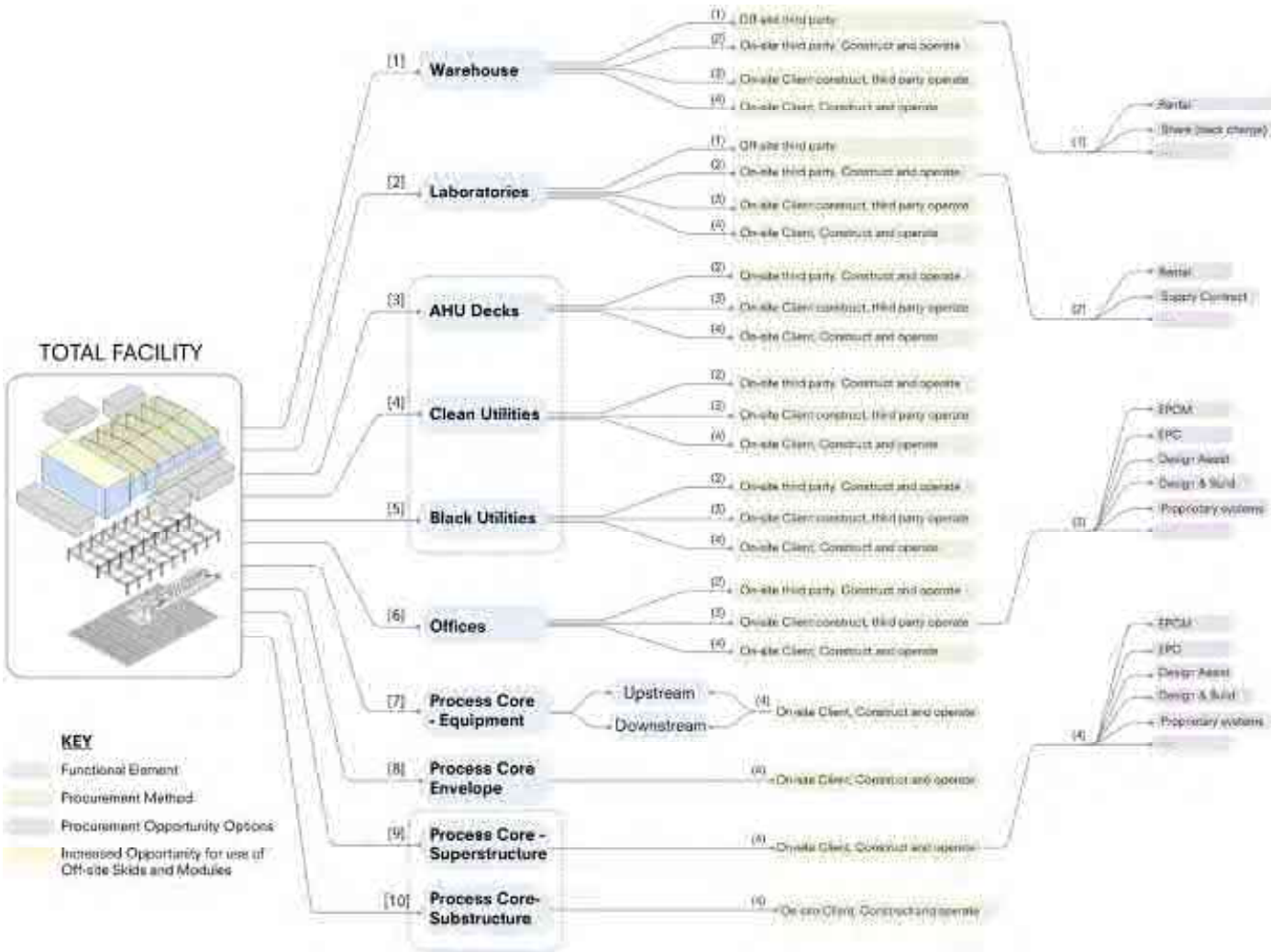

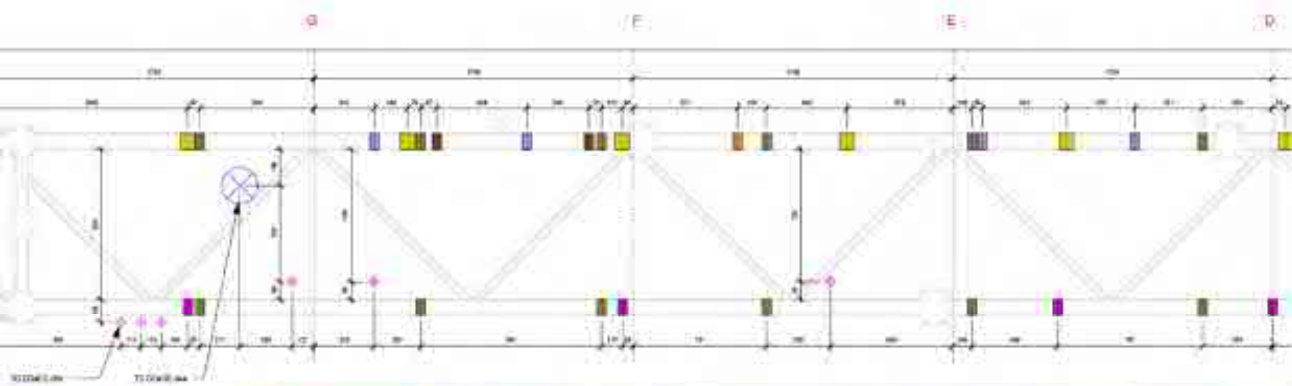

Bryden Wood

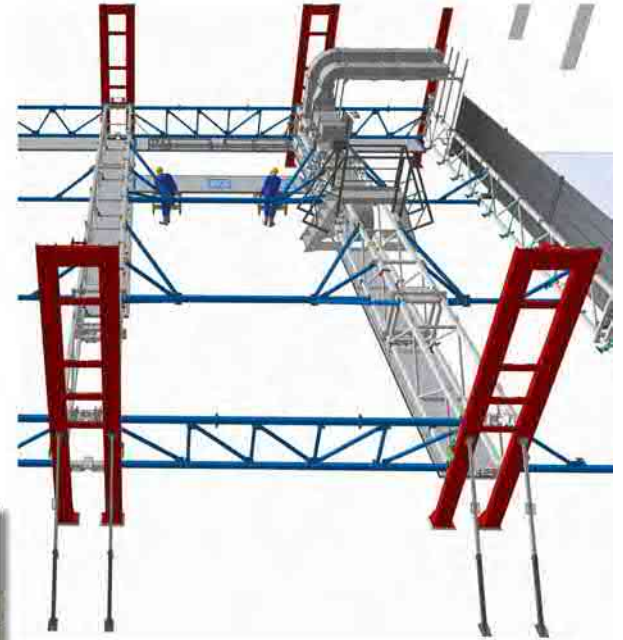
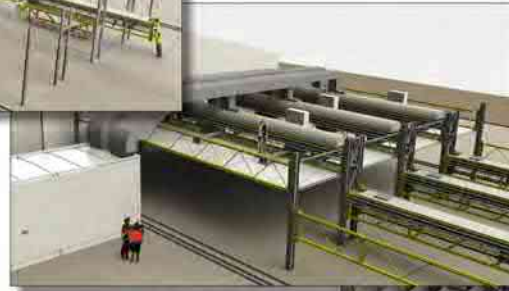

File Manager 10000192289

Preview

- Name:
- 10000192289
  - del Install
  - bracket Drawings
  - Install Sequence
  - Installation RAMS
  - Maintenance Info
  - Packing Instructions
  - Panel Drawings
  - Supplier Details

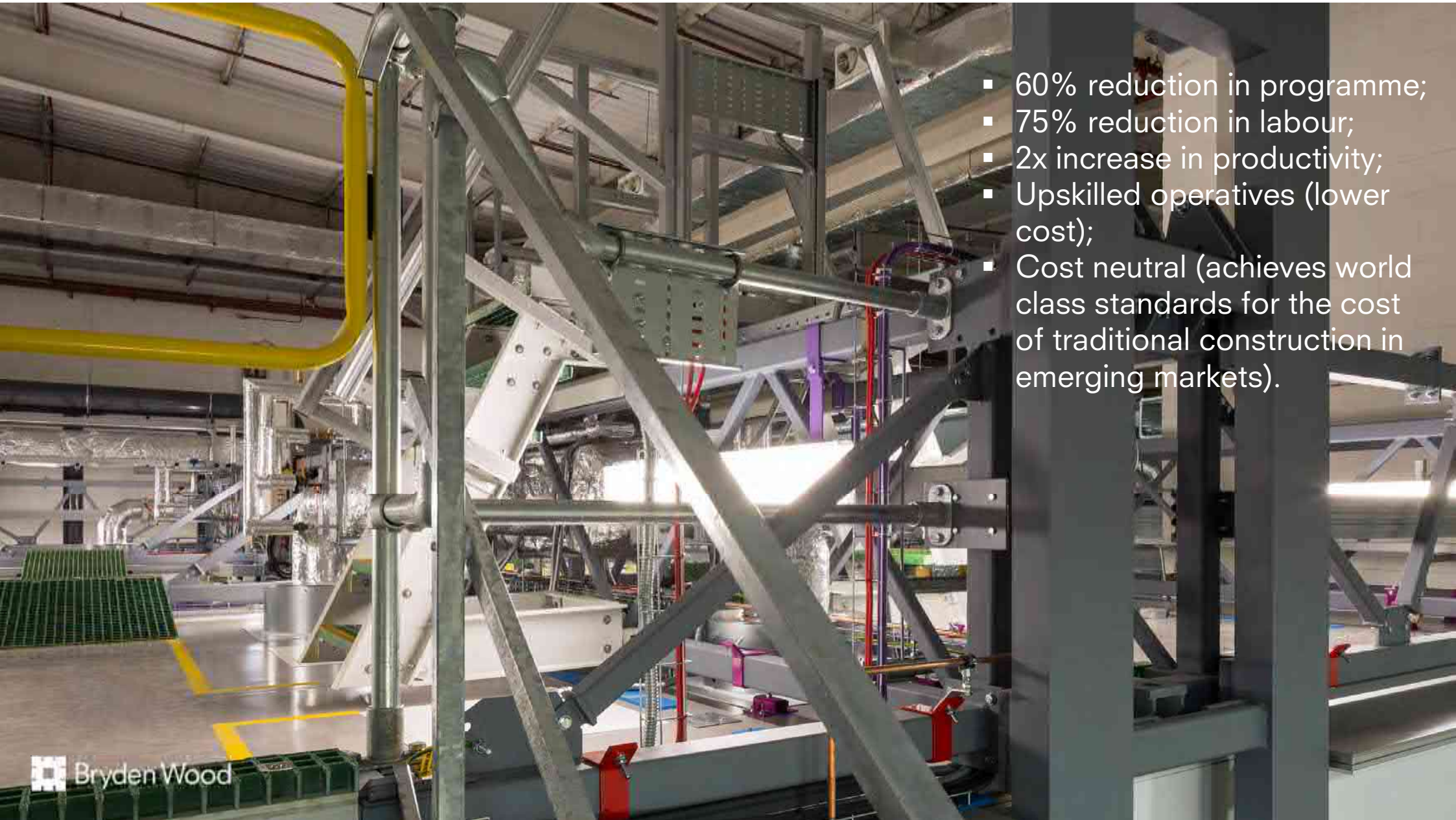

- 60% reduction in programme;
- 75% reduction in labour;
- 2x increase in productivity;
- Upskilled operatives (lower cost);
- Cost neutral (achieves world class standards for the cost of traditional construction in emerging markets).





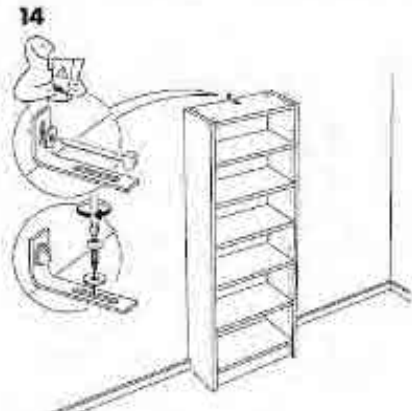
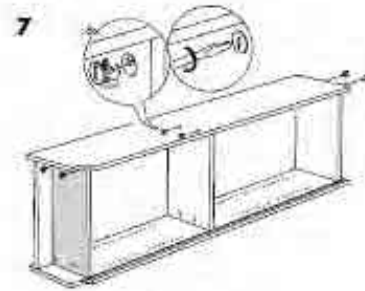
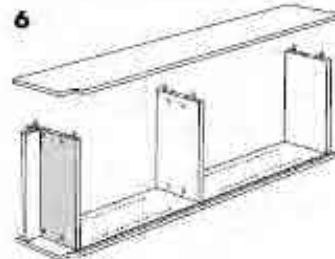
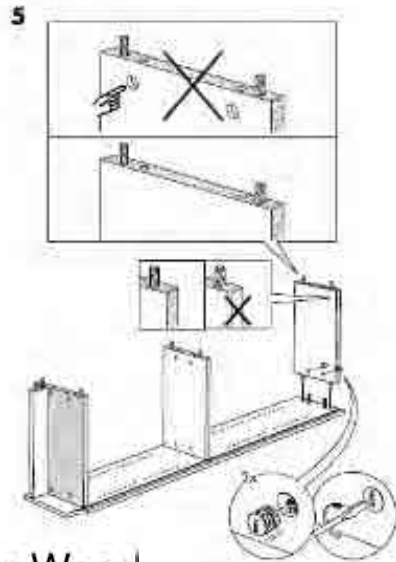
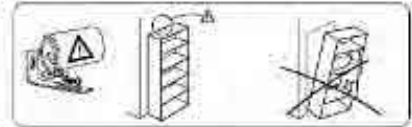
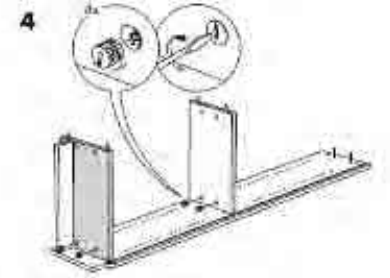
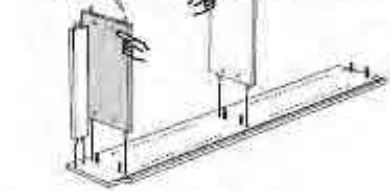
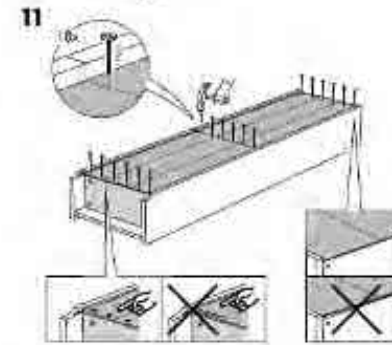
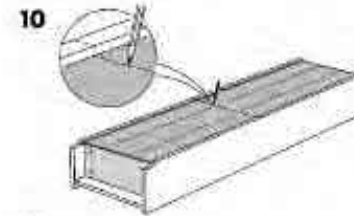
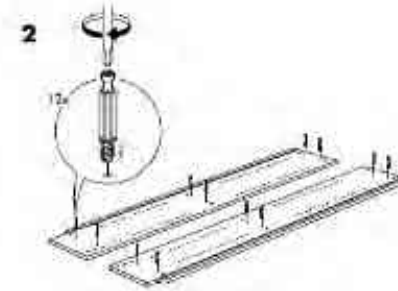
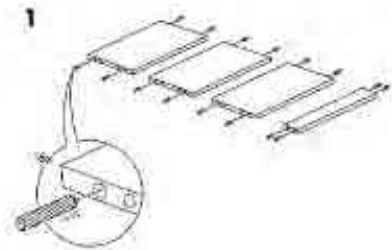
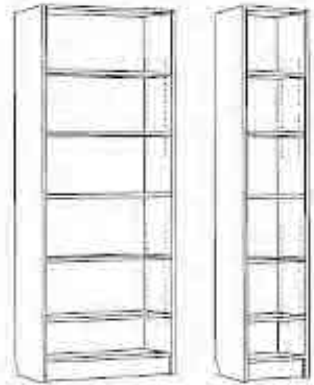

# BILLY

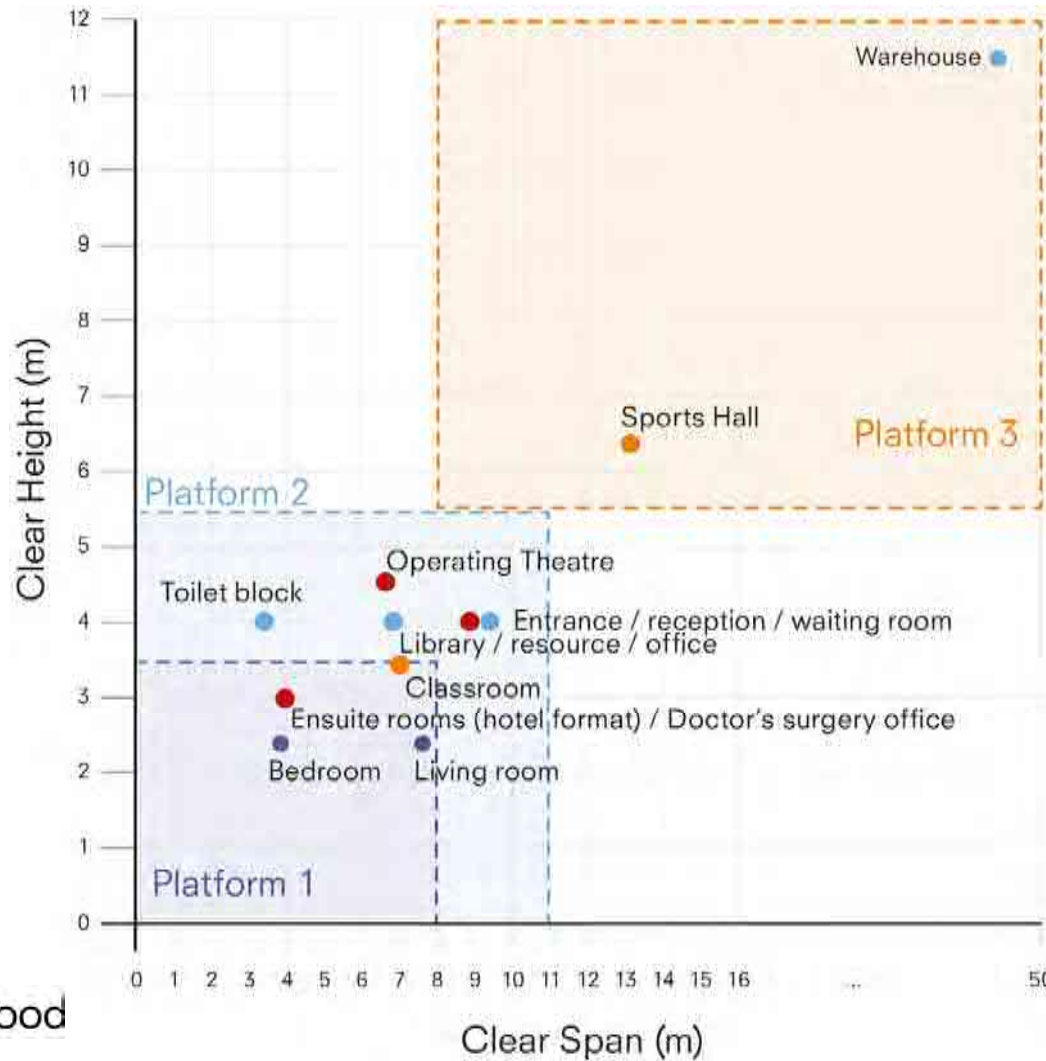

# A Platform-based approach to construction



-  Residential
-  Offices
-  Health
-  School

  
Infrastructure and Projects Authority

  
Ministry of Justice

  
Department for Education

  
Department of Health

  
Ministry of Defence

  
Department for Transport



# Prototyping facility

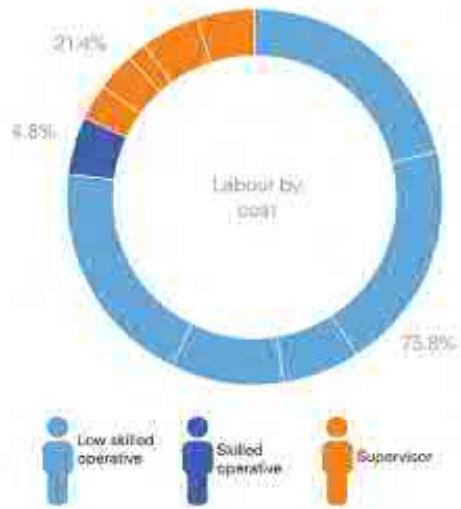

**“The designer grants the Client an  
irrevocable, royalty-free,  
worldwide and non-exclusive  
licence in perpetuity to use, copy  
and reproduce the Materials for any  
purpose whatsoever.”**



Infrastructure  
and Projects  
Authority

Our proposal: a Platform  
approach to Design  
for Manufacture and  
Assembly (P-DfMA)

A platform approach means we will use **digitally designed components across multiple types of asset and apply those components wherever possible**, minimising the need to design bespoke components.

For example, a single component could be used as part of a **school, hospital, prison building or station**.

The three principles are:

1. Design for manufacture;
2. Use a Platform approach;
3. Open for manufacture, use and procurement.

Central logic + **digital configurators**

seismic-school-app.io



Bryden Wood

What is REM (Rapid Engineering Model)?

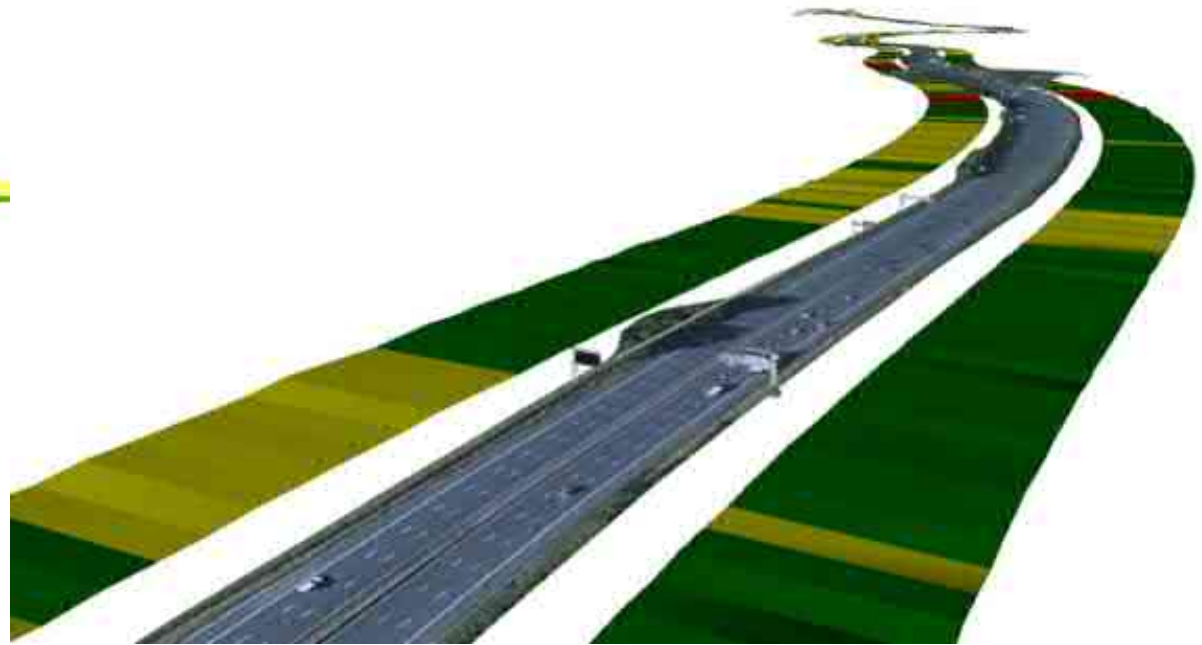
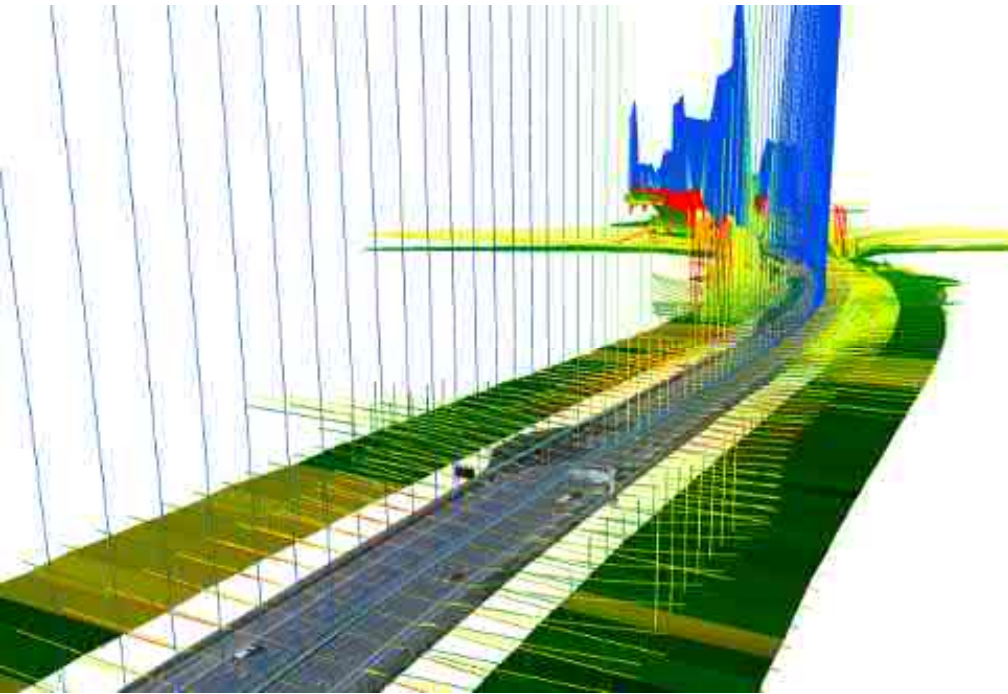



Question: **Would that be useful?**

2017

### Delivery Platforms for Government Assets

Creating a marketplace for manufactured spaces

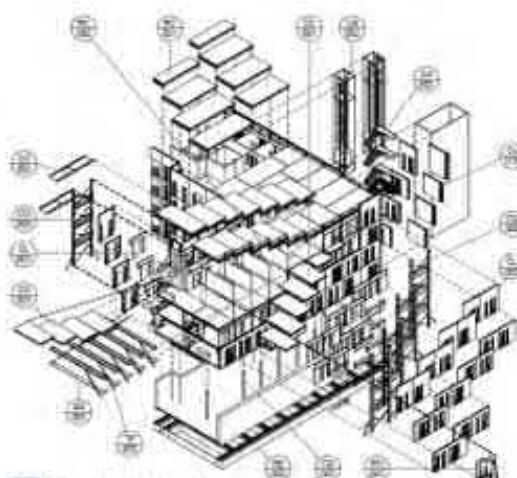

Bryden Wood  
CONSTRUCTION INNOVATION HUB

2018

### Platforms

Bridging the gap between construction + manufacturing

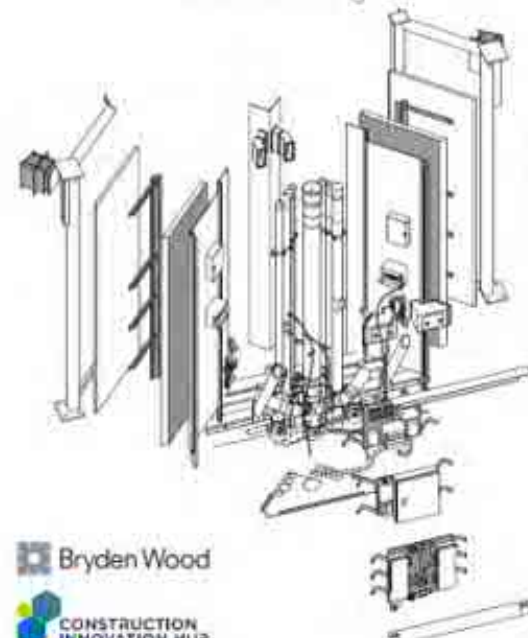

Bryden Wood  
CONSTRUCTION INNOVATION HUB

2019

### Data Driven Infrastructure

From digital tools to manufactured components



Bryden Wood  
CONSTRUCTION INNOVATION HUB

[brydenwood.co.uk/perspectives/178/](http://brydenwood.co.uk/perspectives/178/)

Thank you.



@Jaimie\_BW  
@BrydenWood



Bryden Wood



@brydenwoodtech



@brydenwoodtech